

SECTION II

TM9-2320-273-24P

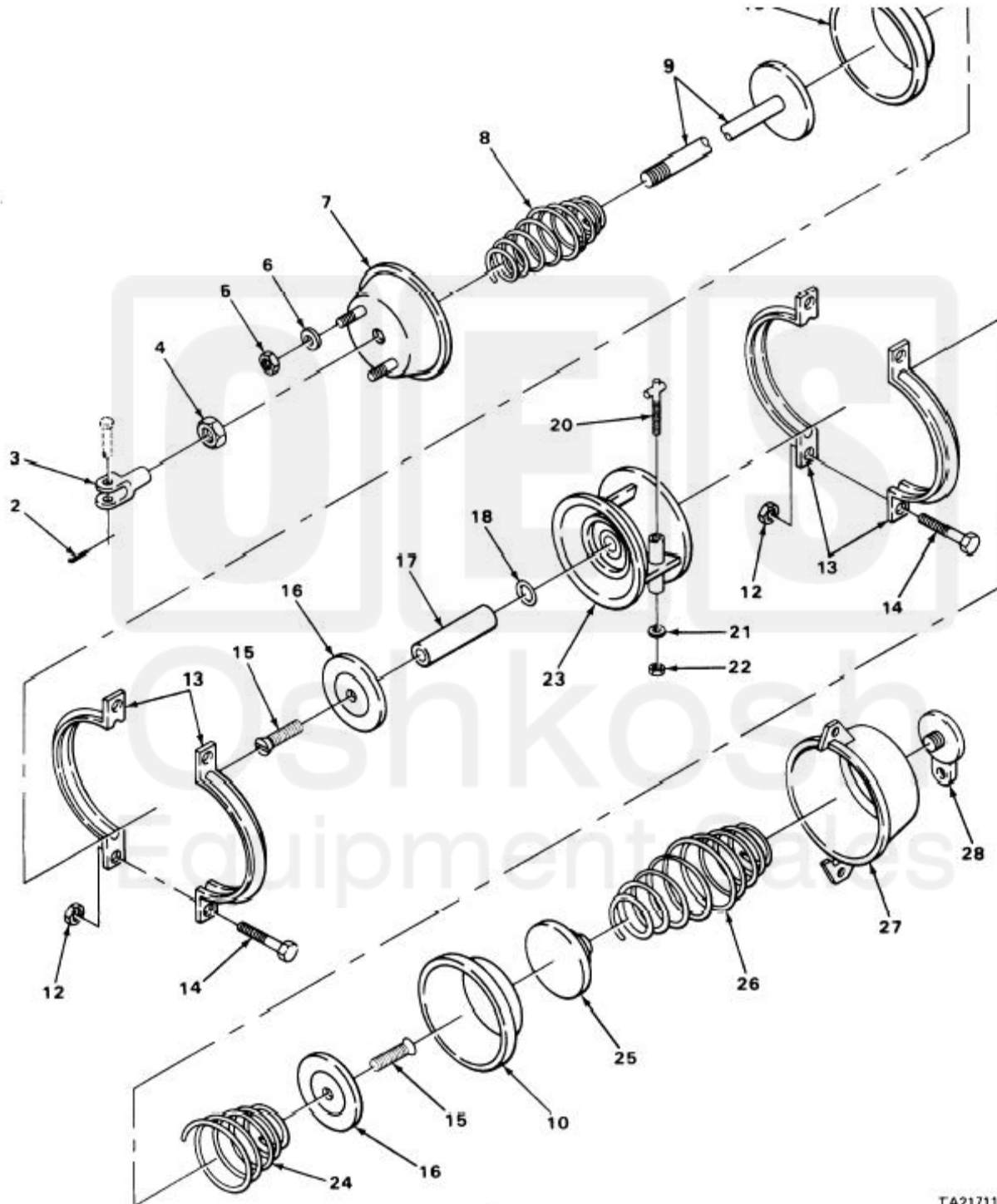

TA217114

FIGURE 191. TANDEM AXLE BRAKE CHAMBER ASSEMBLY.

Current part is item (3) on diagram. Available at www.oshkoshequipment.com

SECTION II (1)	(2)	(3)	TM9-2320-273-24P (4)	(5)	(6)
ITEM NO	SMR CODE	FSCM	PART NUMBER	DESCRIPTION AND USABLE ON CODE (UOC)	QTY
GROUP:1208 AIR BRAKE SYSTEM					
FIGURE 191. TANDEM AXLE BRAKE CHAMBER ASSEMBLY.					
1	PAOFF	50153	162324	BRAKE CHAMBER ASSEM BRAKE, FORWARD REAR AXLE, RH AND REAR-REAR AXLE, LH	1
1	PAOFF	50153	162325	BRAKE CHAMBER ASSEM BRAKE, FORWARD REAR AXLE, LH AND REAR-REAR AXLE, RH	1
2	PAOZZ	96906	MS24665-418	. PIN, COTTER UOC:U22,U23,U24,U25,U26	1
3	PAFZZ	50153	11M018-5/8	.CLEVIS AND U-BOLT	1
4	PAFZZ	96906	MS51968-20	.NUT, PLAIN, HEXAGON	1
5	PAOZZ	98349	L-10-MNS-500-X-9	.NUT, SELF-LOCKING, HE UOC:U22,U23,U24,U25,U26	2
6	PAOZZ	50153	11M066	. WASHER, FLAT	2
7	PBFZZ	50153	1126M015	.HOUSING, AIRBRAKE CH	1
8	PAFZZ	50153	11M016	.SPRING, HELICAL, COMP	1
9	PAFZZ	50153	1126M017	.PUSH ROD ASSEMBLY UOC:U22,U23,U24,U25,U26	1
10	PCFZZ	50153	1126M009	.DIAPHRAGM, BRAKE CHA	2
11	PAFFF	50153	1126M005-CA	.CLAMP	2
12	PAFZZ	50153	11M051	. .NUT, PLAIN, EXTENDED	4
13	XAFZZ	50153	1126M005-1	. .CLAMP, BRAKE CHAMBER	4
14	PAFZZ	96906	MS35751-74	. .SCREW	4
15	XAFZZ	50153	11428R8	.SCREW, SELF-LOCKING	2
16	XAFZZ	50153	11M037	.PLATE, BACKING, BRAKE	2
17	XAFZZ	50153	1126M038	.ADAPTER, PUSH ROD	1
18	XAFZZ	50153	11M114	.PACKING, PREFORMED	1
19	PAFFF	50153	11M011	.STUD ASSEMBLY, RELEA SPRING BRAKE	1
20	PAFZZ	50153	11M011	. .STUD ASSEMBLY, RELEA RETURN RELEASE	1
21	PAOZZ	50153	6152-11M042	. .WASHER, FLAT	1
22	PAFZZ	50153	11M043	. .NUT, PLAIN, HEXAGON	1
23	XAFZZ	50153	1126M001	.ADAPTER	1
24	XAFZZ	50153	11M014	.SPRING	1
25	XAFZZ	50153	1126M003	.PLATE, PRESSURE, AIR	1
26	XAFZZ	50153	1126M006	.SPRING, HELICAL, COMP	1
27	XAFZZ	50153	1126M002-S	.BODY, CHAMBER, AIR BR	1
28	PAOZZ	50153	11M012	.PLUG, CHAMBER TOP	1
END OF FIGURE					

Current part is item (3) on diagram. Available at www.oshkoshequipment.com